



FORD & PARTNERS

— ESTATE AGENTS —



Sheridan Court High Wycombe HP12 4FF



Sheridan Court High Wycombe HP12 4FF

£260,000

A two-bedroom, two-bathroom apartment available to purchase with no onward chain located in small exclusive development.

Description

Upon entering, you are welcomed into a spacious central hallway. The hallway provides access to two generously sized double bedrooms, including a principal suite with an ensuite shower room, a modern family bathroom, and a bright open-plan kitchen, dining, and living area.

The contemporary kitchen is well-equipped with an integrated oven, four-ring gas hob, 50/50 fridge freezer, dishwasher, and a washing machine (to be negotiated separately). The apartment also benefits from gas central heating, double glazing, a long leasehold, and a covered balcony offering far-reaching views. Allocated parking is also included.

Situation

High Wycombe town provides an extensive range of shopping facilities, as well as a sports centre and multi-screen cinema complex. Surrounding the town is a selection of golf courses and other recreational amenities while a short drive finds the River Thames and the historic town of Marlow.

For the commuter there is a frequent rail service from High Wycombe to London Marylebone and the area also benefits from being close to the M40, providing links to the national motorway network including the M25 and easy access to Heathrow Airport.



Floor Plans

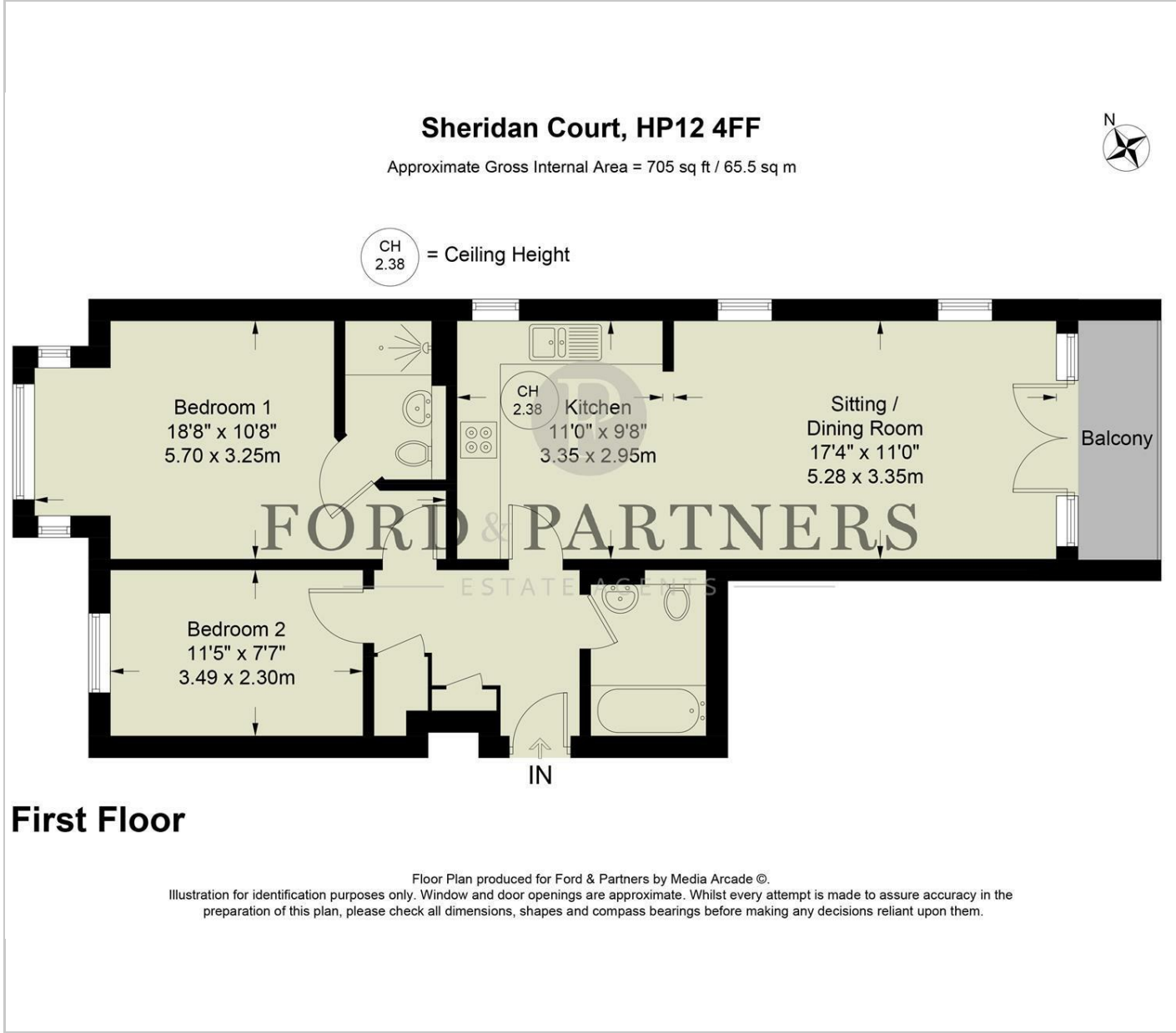

Area Map

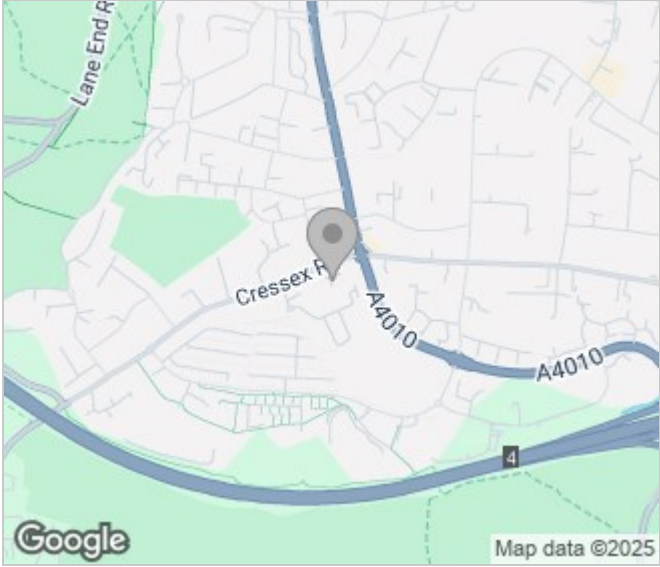

Energy Performance Graph

